

National Gallery - East Building Washington, DC

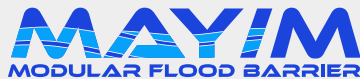
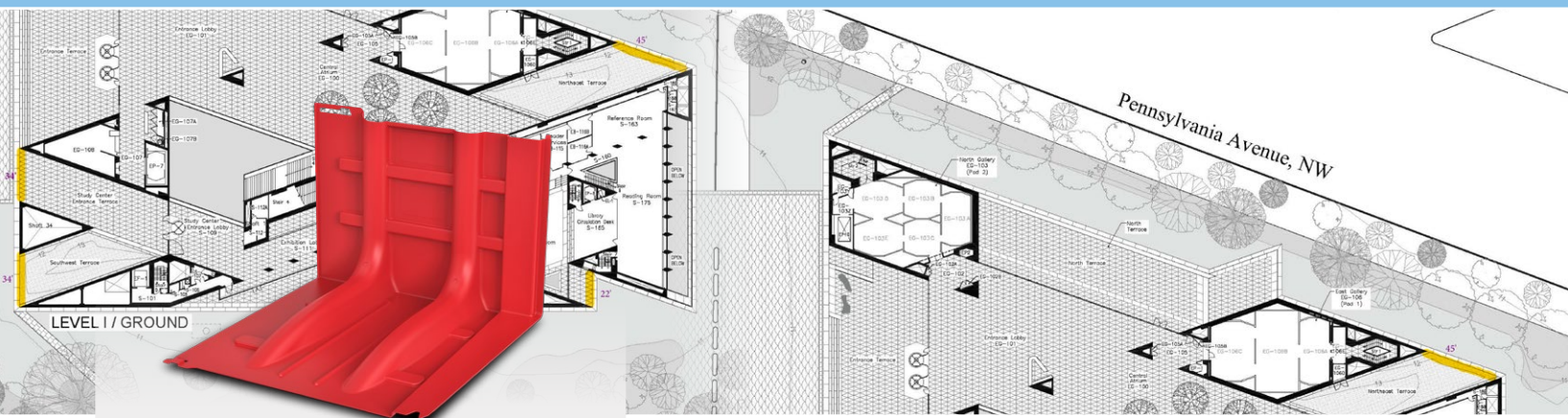

Client:

The National Gallery of Art -
Washington, DC

The Challenge:

The National Gallery of Art resides near the National Mall of the nation's capital. Sitting in the lowest area of Washington, DC has resulted in periodic and significant flooding events at the Mall since the 1880's. Recently The National Gallery underwent renovations and reopened to the public on June 18th, 2022. Its unique architectural design, by I.M. Pei, features a variety of unique wall angles. Having a series of different angles and entryways, The National Gallery required a flexible flood solution to stay protected against future flood events.

Goals:

Garrison's goal with the National Gallery was to provide a series of flexible flood protection solutions to help protect the priceless works within. With every opening to be protected being unique, Garrison needed to provide customized layouts that provided the necessary protection. Our mission was to find the best possible portable flood protection solution to account for the detailed architectural design of the National Gallery.

Solution:

The Mayim Flood Barrier was the perfect solution for The National Gallery's protection needs. We concluded that the 5 separate entryways, ranging from 12 feet to 45 feet wide, could use Mayim Barriers to block water from making its way inside the Gallery. Accounting for the unique angles, we decided to use Mayim Straight barriers, Curved Barriers, and End Gables with neoprene seals to create custom length sections that could span the openings yet still connect with the walls at the unique angles of the building.

Result:

With our help, The National Gallery was able to secure the ideal amount of Mayim Barriers to help completely protect each of the 5 entryways into their building. The architectural design with unique angles did not have to compromise on any level of protection due to the flexibility of the Mayim Barriers. Going forward, The National Gallery now has protective materials that fit perfectly into their emergency plan. With the ability to quickly deploy protective flood measures, future repairs and damage will be mitigated and the need for closures due to flooding will be minimal.

Summary:

The National Art Gallery was built in 1978 in Washington, DC near the National Mall. Inside the Gallery are priceless works of contemporary art. The museum has thousands of visitors each day and its mission is to serve the United States of America in a national role by preserving, collecting, exhibiting and fostering the understanding of works of art.

Since the 1880's, the area in which the National Mall and National Art Gallery resides has experienced periodic flood events that have had severe ramifications on the existing infrastructure. Flooding is the most common natural disaster in the world and accounts for billions of dollars in damages each year.

Recently, The National Gallery underwent a series of renovations. With its reopening to the public on June 18th, 2022 there was a heightened level of importance being put on procuring protective flood control measures. Garrison Flood Control specializes in providing effective modular flood barrier solutions that fit perfectly into the plans of facilities of the size and importance of the National Gallery.

CASE STUDY: National Gallery - East Building, Washington, DC

With 5 specific entryways ranging from 12 feet to 45 feet wide, the mission was to find the best possible solution to stop potential floodwaters from entering the Gallery and damaging the priceless works within. The architectural design by I.M Pei is intricate, with a series of unique angles that needed to be accounted for. No corners could be cut in trying to find a protective solution.

Garrison Flood Control was able to quickly provide the Mayim Flood Barrier as a solution for future flood threats. Mayim Flood Barriers interlock to connect multiple pieces in order to achieve a desired length of flood protection. Turns allow meeting up with walls at varying angles. This solution was perfect for the Gallery's entryways. Our curved Mayim Barrier pieces allowed for a level of flexibility to work in tandem with the architectural design. Additionally, the End Gable pieces that seal to the edges provide a neoprene seal which keeps flooding from seeping through into the building.

Heading into the future, the National Art Gallery has a secure protocol in place for whenever a flood threat arises. Mayim Flood Barriers help to achieve a rapidly deployable and easy to use flood protection system. Coming off of recent renovations, the Gallery can feel secure in knowing that the pieces of art inside are protected from the dangers of future flooding.

Takeaways:

- Historically lower areas within metropolitan cities have an increased risk of flooding. Therefore, having quick deployment solutions is imperative for any business.
- Having been recently renovated, The National Gallery can now keep those renovations and the art work within as protected as possible, with proper flood solutions provided by Garrison.
- Mayim Flood Barriers sections easily and quickly connect without any tools, allowing for rapid deployment as flood threats develop.
- Mayim Flood Barriers efficiently block, hold back and redirect water in its path and will help keep the National Gallery entryways safe, protecting the valuable art pieces inside.
- The National Gallery has now procured the most important piece of protection for their emergency flood plan.
- The effective flood measures in place allow for peace of mind when showcasing new and existing pieces within the Gallery.

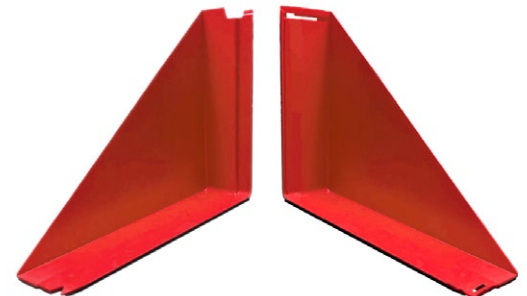
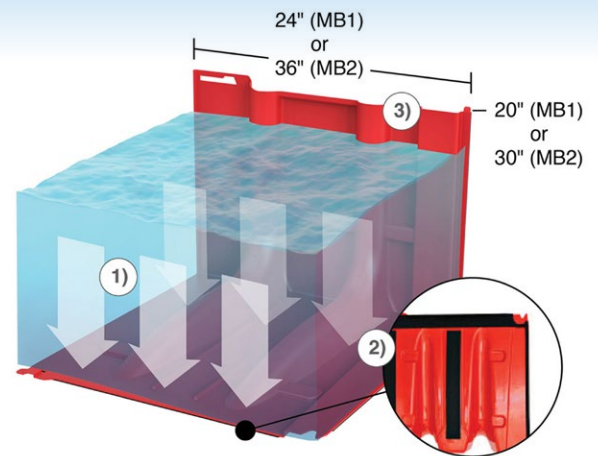

GARRISON
FLOOD CONTROL