

Flooding can strike unexpectedly, but with a little preparation, your Hammerhead Aluminum Flood Plank System will be ready when you need it most. Taking these proactive steps now will minimize stress and maximize protection when severe weather hits.

Inventory and Check Components

- Make sure you have all Hammerhead components accounted for and ready to deploy.
- Inspect parts to check for any dings, dents or any issues before you need it.

Inspect Caulking

- **Visually examine** the caulking around the mounting posts:
 - 1) Check seal between the post and the wall.
 - 2) Check caulk/seal between the base of the post and the ground.
- **Look for signs of cracking, drying, or gaps** where the caulk has pulled away from the surfaces.
- **Check the depth of the caulk** to ensure there's a sufficient amount for a watertight seal. A good rule of thumb is for the bead of caulk to be slightly wider than the gap it's filling.
- **Re-caulk** if you find any cracks, gaps, or insufficient caulk by removing the old damaged caulk with a utility knife or caulk remover tool. Clean and dry before re-applying.



Additional Flood Protection Strategies:

- **Consider Using A Sump Pump:** Consider using a sump pump behind your Hammerhead system. This can help reroute any minor seepage or rainwater runoff that might collect on the backside, further enhancing your flood protection.
- **Minnow Water Absorbing Bags:** For additional peace of mind, you may consider having a supply of Garrison's [Minnow water absorbing bags](#) on hand. These can be strategically placed behind the Hammerhead system to soak up any minor seepage that might occur, preventing it from becoming a nuisance.
- **Evacuation Planning:** Remember, even with floodproofing measures in place, safety always comes first. As FEMA advises, if you have installed dry floodproofing measures like the Hammerhead system, it's crucial to evacuate your property well in advance of a major flood event.

Inspect Planks

- Tension bottom plank down so its fully compressed to ensure a seamless seal across the bottom plank.
- Before installing each plank, check that the rubber seals are intact.
- When installing each plank into the posts, secure the tension plate and bolts to pressure planks down to create a tight seal.
- Use the top tensioning plate to pressure planks downward, enhancing the seal between them.

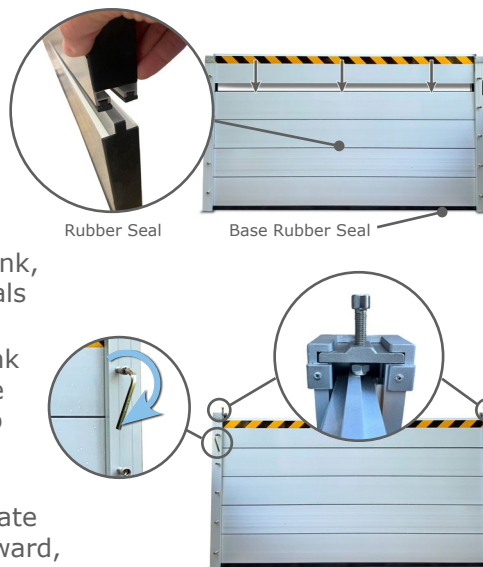

GARRISON

FLOOD CONTROL

(929) 299-2099
sales@garrisonflood.com
www.garrisonflood.com